

По вопросам продаж и поддержки обращайтесь:

Алматы (7273)495-231
Ангарск (3955)60-70-56
Архангельск (8182)63-90-72
Астрахань (8512)99-46-04
Барнаул (3852)73-04-60
Белгород (4722)40-23-64
Благовещенск (4162)22-76-07
Брянск (4832)59-03-52
Владивосток (423)249-28-31
Владикавказ (8672)28-90-48
Владимир (4922)49-43-18
Волгоград (844)278-03-48
Вологда (8172)26-41-59
Воронеж (473)204-51-73
Екатеринбург (343)384-55-89
Иваново (4932)77-34-06
Ижевск (3412)26-03-58
Иркутск (395)279-98-46
Казань (843)206-01-48

Калининград (4012)72-03-81
Калуга (4842)92-23-67
Кемерово (3842)65-04-62
Киров (8332)68-02-04
Коломна (4966)23-41-49
Кострома (4942)77-07-48
Краснодар (861)203-40-90
Красноярск (391)204-63-61
Курган (3522)50-90-47
Курск (4712)77-13-04
Липецк (4742)52-20-81
Магнитогорск (3519)55-03-13
Москва (495)268-04-70
Мурманск (8152)59-64-93
Набережные Челны (8552)20-53-41
Нижний Новгород (831)429-08-12
Новокузнецк (3843)20-46-81
Новосибирск (383)227-86-73
Ноябрьск (3496)41-32-12

Омск (3812)21-46-40
Орел (4862)44-53-42
Оренбург (3532)37-68-04
Пенза (8412)22-31-16
Пермь (342)205-81-47
Петрозаводск (8142)55-98-37
Псков (8112)59-10-37
Ростов-на-Дону (863)308-18-15
Рязань (4912)46-61-64
Самара (846)206-03-16
Санкт-Петербург (812)309-46-40
Саранск (8342)22-96-24
Саратов (845)249-38-78
Севастополь (8692)22-31-93
Симферополь (3652)67-13-56
Смоленск (4812)29-41-54
Сочи (862)225-72-31
Ставрополь (8652)20-65-13
Сургут (3462)77-98-35

Сыктывкар (8212)25-95-17
Тамбов (4752)50-40-97
Тверь (4822)63-31-35
Тольятти (8482)63-91-07
Томск (3822)98-41-53
Тула (4872)33-79-87
Тюмень (3452)66-21-18
Улан-Удэ (3012)59-97-51
Ульяновск (8422)24-23-59
Уфа (347)229-48-12
Хабаровск (4212)92-98-04
Чебоксары (8352)28-53-07
Челябинск (351)202-03-61
Череповец (8202)49-02-64
Чита (3022)38-34-83
Якутск (4112)23-90-97
Ярославль (4852)69-52-93

Россия +7(495)268-04-70

Казахстан +7(7172)727-132

Киргизия +996(312)96-26-47

<https://gea.nt-rt.ru/> || gsg@nt-rt.ru

ЗАЛЫ ДОЕНИЯ SIDE-BY-SIDE Технические характеристики



Side-by-Side Milking parlour Global 90i

Comfortable milking for cows and people
with the Global 90i

... first class milking

Global 90i means:

A comfortable, smooth milking experience for the cows and operators. With its compact design, the Global 90i does not take up a lot of room, and only necessitates the operator to cover short distances regardless of the size of the parlour. But it also offers a fantastic amount of space for every breed of cow. The modern, curved, hot galvanised frame can withstand any load without bending.

First class comfort: individual indexing

Your cows immediately get into the best position for milking with the help of the individual indexing system. The weight of the individual exit gate presses on the animal's shoulders, easing it safely and comfortably back towards the operator. It is then in the correct place and accessible to the operator for milking.

Open door

The wide entrance invites your cows into the milking parlour: The cows move into place quickly, comfortably and without any stress; once in position the cow is in its own stall, undisturbed by others. When the last animal is in its stall the entrance gate closes flush with the last milking place, and the whole group is well-positioned.

Clean

The sturdy, stainless steel dung channel protects the operator from getting dirty, and keeps the work area exceptionally clean.





Your free space.

Together with the individual indexes the animal-friendly design gives your cows the amount of space and room for movement it requires. **The effect: less stress for man and animal.** The quick exit rounds off the package and makes Global 90i into one of the “quickest” milking parlours with high throughput.

Individual exit of animals!

In addition to the quick exit in the Global 90i, it is also possible to select each individual animal. Each front segment can be opened independently to release the individual animal from the milking parlour in the shortest time (option). **This saves valuable time, cost and trouble.**



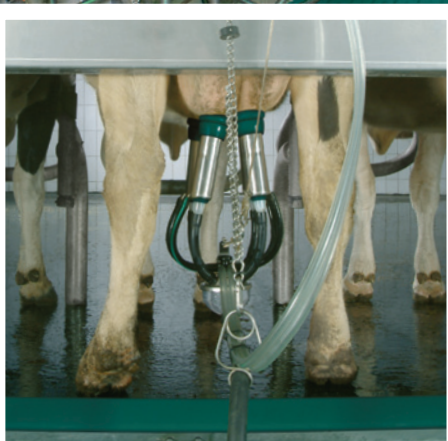

Counterbalance secures the path of the hose. Depending on the individual milking parlour equipment, you can start the milking process quite conveniently with your leg or just by slightly lifting the milking equipment. No matter the equipment on which you decide, you have both hands free for quicker positioning.



Design with MultiLine

In connection with MultiLine, you can recognise Global 90i immediately by the unmistakable operation front. In this clear, easy-to-maintain work environment, milking is fun. The milking technology integrated in MultiLine is protected against dust and dampness. For the few, important servicing tasks, the MultiLine cladding can be easily opened with two movements of the hand. MultiLine helps to keep down the noise level in the milking parlour for human being and animal.

First-class flexibility

Global 90i comes starting from the size range 2 x 8 to 2 x 50 also in one-sided design – for any size of herd. If your herds grow, then you just extend your milking parlour conveniently by individual modules. Global 90i increases the throughput continuously! Whether for medium-sized or big herds. Long life, higher profitability and effective work distinguish this milking parlour with its high stability and security for human and animal.

With the **EGO 100 lifting floor**, ergonomic body posture means noticeable relief for your body. (Option)



Model:
Global 90i without subway



Model: Global 90i Subway

In this model, the service-relevant milking technology components are mounted below the milking pit (central subway) or below the standing area for the animals (dual subway). The subway system offers a guarantee for a clean and dry, easily accessible work environment and enables servicing work even during milking operation. The lifetime of all important components is extended by this.

IllumiCurb

Parlour lighting where you need it

Early detection of injuries and changes in the udder condition and teats is becoming ever more important – in particular from an economic point of view.

The robust LED strip, IllumiCurb, gives full coverage to the udder and simplifies your milking routine. Changes in the udder condition can be detected more easily and treated in good time. A good visualisation of the udder is an important step towards achieving improved udder health and increased milk production.

IllumiCurb ensures adequate lighting of the udder (optional retrofit).



DairyDesignService:

On-site consultancy for you is particularly important to us.

You can profit thereby from the experience of our worldwide network of excellent “dairy design experts”. Our consultancy does not finish on completion of the system. We shall instruct your staff expertly and guarantee full utilisation of your system through continual training.

We will support you from the very beginning.

Standard and installation plans will help you in the planning and construction. In addition, we can draw up individual solutions for you on the CAD system. You can see immediately what your desired system looks like no matter of which size, planned consistently in accordance with your individual demands.

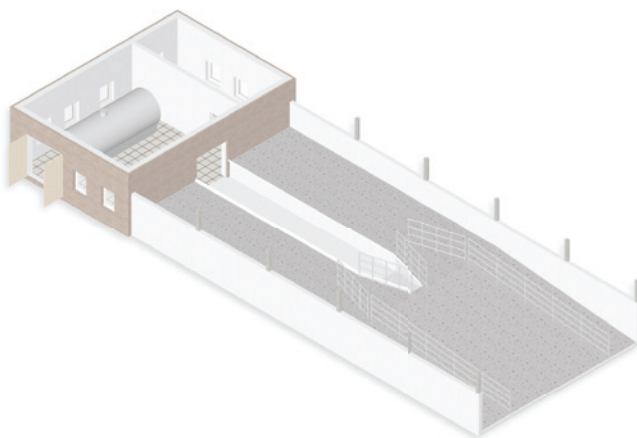

Your benefits at a glance

- Convenient milking for human being and animal
- Frictionless and stress-free milking process with short work ways
- Sufficient space for any race of cow
- Easy milking parlour access (operability)
- Optimum, individual position of the animals
- High level of stability through robust construction for the security of human being and animal
- Quick exit for high throughput performance
- Little servicing through high-quality components

Magnum 90i™ Individual Indexing Parallel Stall

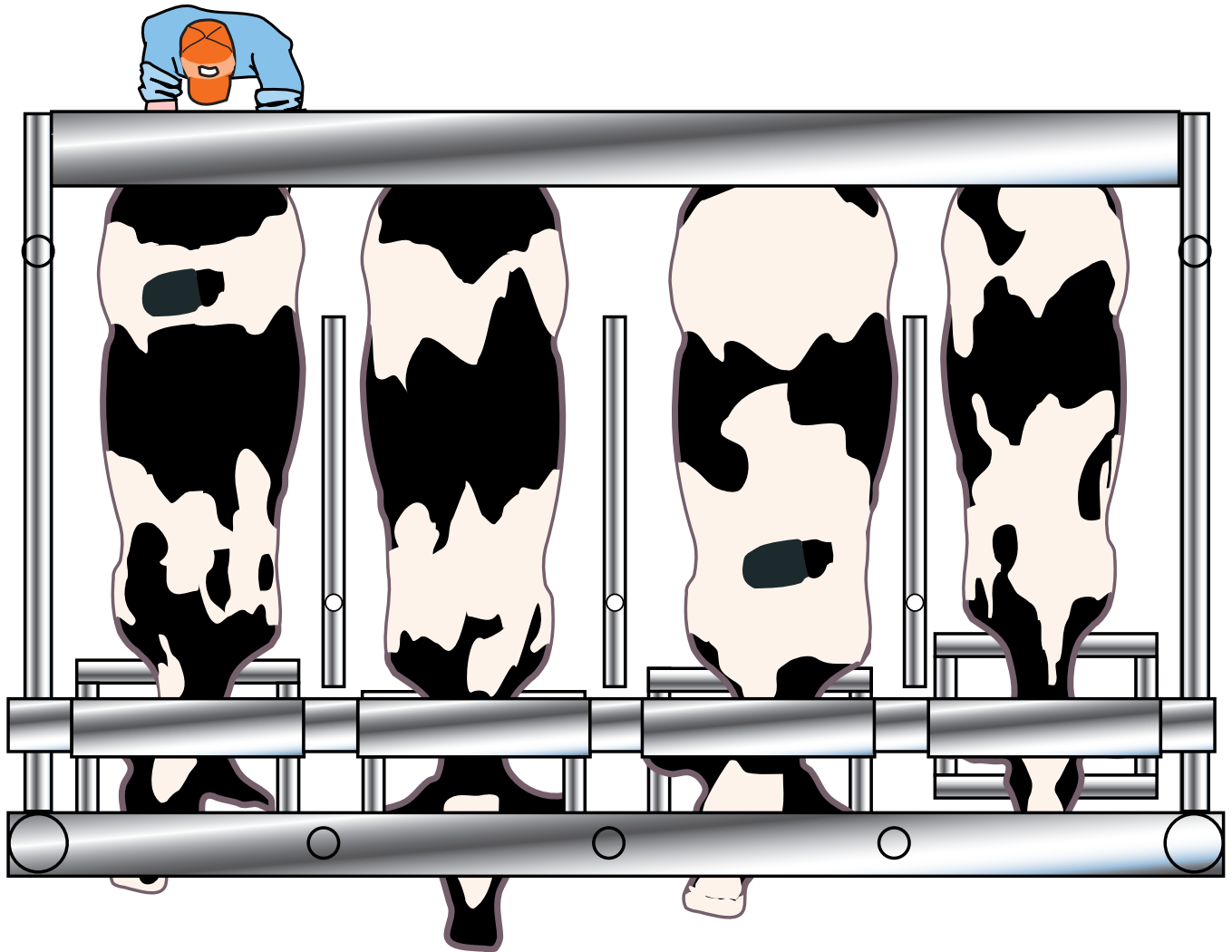

Cow comfort — sloped butt pans allow the cow to comfortably stand against the back of the stall. Open center sequencing gates allow the widest part of the cow to fit in the gate opening.

Cow positioning — cows stand closer to the operator. Individual gravity indexing gently positions both large and small cows. Telescoping entrance gate centers the last cow in her stall.

Operator safety — comfortable, consistent cow positioning keeps the udder within the operator's reach. Heavy-duty stainless steel butt pans eliminate the need for a separate kick rail.

Throughput — designed for rapid entrance and exit for optimum throughput.

The industry leader

Throughput — the Magnum 90i™ is designed for rapid exit. Also, the wide entry lane and sloped butt pans allow cows to load quickly.

Individual gravity indexing provides flexible lunge space. The open center sequencing gates provide optimum loading speed and cow comfort.

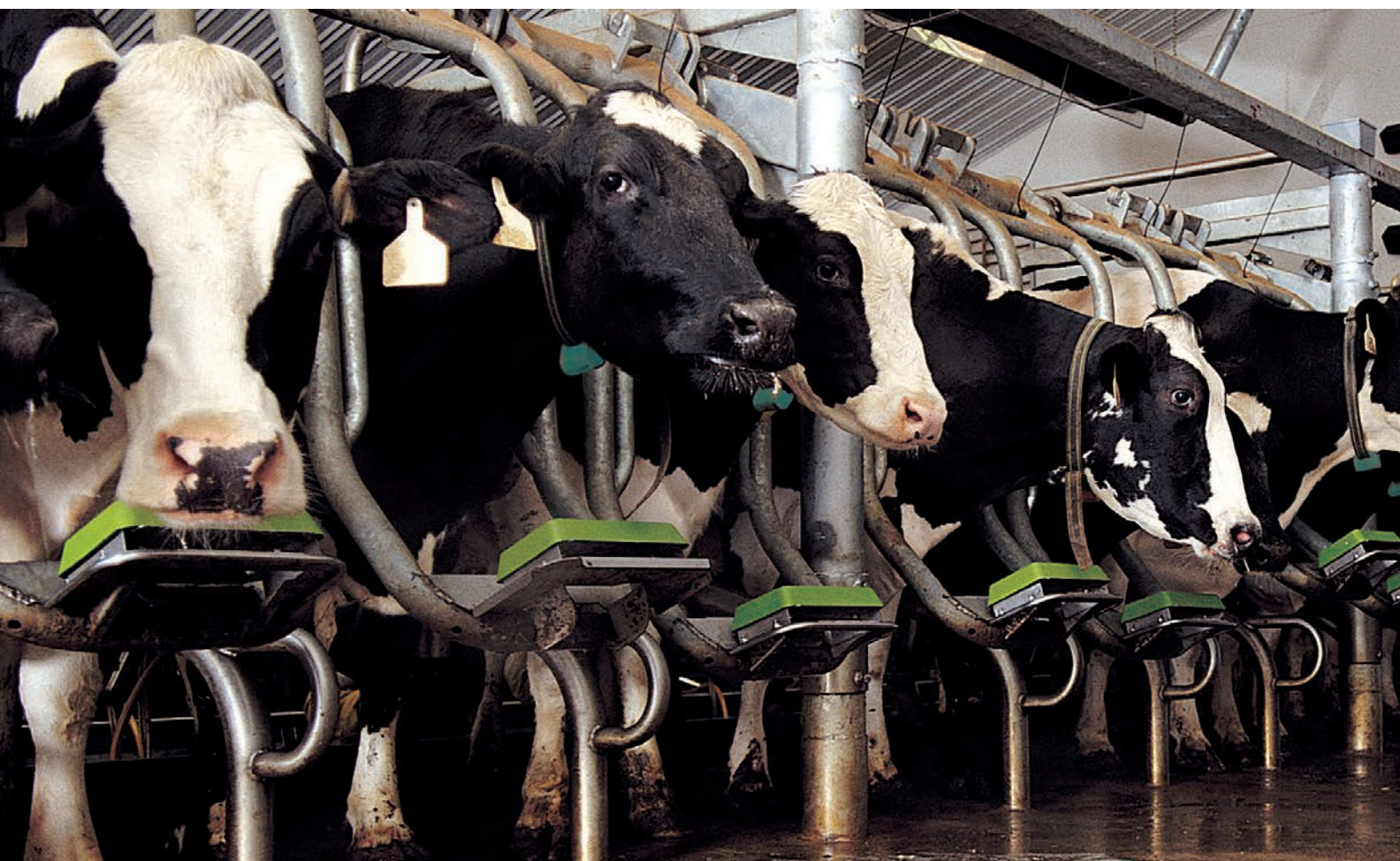

The Magnum 90i™ stall automatically provides pre-indexed cow positioning, allowing the operator to start prepping cows as soon as they load. The individual indexing also helps to provide proper udder presentation, optimizing operator procedures, including unit attachment to improve throughput.

Unique features



Cow comfort — sloped butt pans allow the cow to comfortably stand against the back of the stall. Open center sequencing gates allow the widest part of the cow to fit in the gate opening.

The double wall sequencing gate — supported with an internal spring, this gate is the heaviest in the industry. Optional, removable sequencing gates make it easy to remove downed animals.



Entrance gate load position provides a wide entry lane.



As it closes, the telescopic entrance gate helps center the last cow.

Telescoping entrance gate — centers the last cow in her stall. The gate does not hinder cow traffic by opening toward the cow trying to enter the parlor.

Operator friendly design — provides better cow access, improved safety and is easier to keep clean. Because of individual indexing, the cows stand closer to the operator.

Optional Medallion® cabinets keep operators cleaner, reduce noise and protect parlor systems.



Wide selection of sizes — choose from double 4 to double 80 configurations; single side configurations are available by special order.

Parlor planning assistance — GEA Farm Technologies will design a floor plan to meet your needs exactly. Give us your specs and we'll prepare the blueprint.

Magnum 90i Specifications	
Main support posts	5½" O.D. galvanized with stainless steel rust shields for corrosion resistance
Support arches, exit gate, sequencing gates and telescoping entry gates	Galvanized
Sequencing gate posts	Stainless steel
Splash shield	11 gauge stainless steel
Curbing	10 gauge stainless steel
Open center sequence gates	Eliminates hard surface contact with the cow
Fully suspended backend	No posts in the way of operation, no beams across parlor pit

Magnum 90i™ VL Individual Indexing Parallel Stall with Vertical Lift Exit Gate

Elevate your milking operation to new heights with the vertical lift!

The fastest exit in the industry — for more turns per hour and a more efficient operation. The cow containment gates and posts move completely up and out of the way, allowing unobstructed cow exit. The exit gate lifts fully in four seconds or less, making sure that the stall structure is out of the way when cows pass underneath.

The sequence gates of the Magnum 90i™ VL lift up and out of the way — for faster operation and for unrestricted access to possible downed animals. The clear, flat floor surface allows for more efficient maintenance and is easier to clean.



The sequence gate is spring loaded — for more efficient parlor operation. A spring positively pulls the sequencing gate into the load position after the cows exit. Therefore, there is a lower probability of short loading the parlor due to a single sequence gate being out of place when compared to gravity-operated sequence gates.

The sequence gate is level with an open loop — which is easier on the cows. The level sequencing gate does not hit a cow's hip bones like other parlors with slanted, gravity-dependent sequence gates. This open loop design also gives the barrel of the cow space, eliminating hard surface contact at the widest part of the cow.

A wide entry area provides smooth cow flow — for safer milking and happier cows, ensuring cow comfort and easy exit.

The most standard clearance in the industry — standard 63" clearance beneath the main beam and under exit gates so even your largest cows can exit calmly and comfortably.

Fewer parts in concrete — allows for easier clean-up and faster cow flow.

The individual indexing of the Magnum 90i VL exit gate — also adds the benefit of better, safer milking. Cows of all different sizes are positioned properly in the stall. The indexing gate gently pushes the cow back against the butt pan, moving the udder closer to the operator. Benefits are seen in faster loading — the cow has lunge space to make the turn

into the stall easier and faster. Cows can be milked faster with the cow ready and in the proper milking position as soon as she enters the stall. There is no waiting for the parlor to be completely full to index the cow into proper milking position. Cows are indexed based on their individual length, allowing them to stand comfortably.

The gravity-controlled exit gates — allow for comfortable cows and low maintenance. The exit gates use no springs or cylinders, only the weight of the gate (approximately 28 lbs./ 12.7 kg). The exit gate is designed to touch the cow at a specific point that encourages the cow to index with very little force.

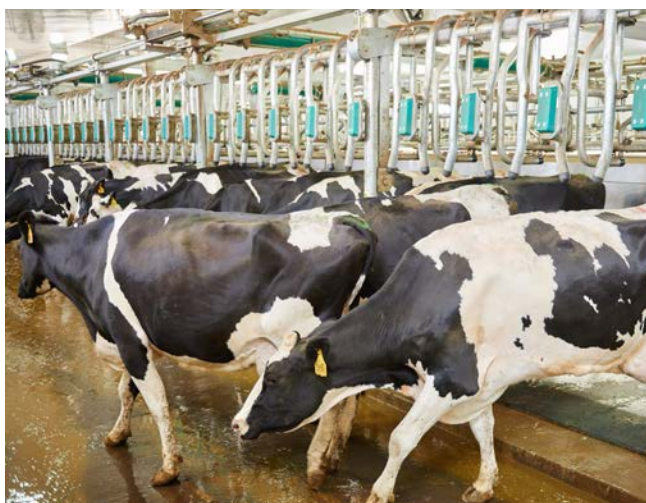

...for the fastest exit in the industry



The heavy-duty construction of the Magnum 90i™ VL is designed for the demands of large, commercial dairies, milking 24 hours a day. The vertical lift exit gate allows for fast exit, increasing efficiency and turns per hour.

The individual gravity indexing gate positions the cow properly with individual release to allow for specialized cow management.

Magnum 90i™ VL Specifications	
Main support posts	4½" O.D. galvanized with hot-dip galvanized rust shields (Stainless steel rust shields are optional)
Support arches	Galvanized box beam superstructure
Exit gate, sequencing gates and telescoping entry gates	Galvanized
Splash shield	11 gauge stainless steel
Curbing	Optional – 11 gauge stainless steel
Stall width	28 ¾"
Height required	137 ⅞"



The manual individual cow exit gate quick-release — is designed for specialized cow management. Individual cows can be released for special handling and sorting.



Magnum 90i™ VL features

Meeting your needs — no matter what is most important to you

Need	Advantage of Magnum 90i VL
Cow comfort	Open-center sequence gate allows for greater space for the barrel of the cow. With individual indexing, cows are positioned properly according to their individual length and size, allowing them to stand comfortably. The large air cylinder for the exit gate, with remote-mounted reserve air tank, provides smooth, even and rapid lifting of the exit gate (four-second lift time). This fast operation reduces the chance of exiting cows hitting the stall structure as they walk out.
Cow positioning	Individual indexing exit gate allows cows of all sizes to be positioned properly in the stall. It gently pushes the cows back against the butt pan, moving the udder closer to the operator. The entry gate closes at an angle to define the last stall, allowing for refined cow positioning for easy operator access.
Operator ease and safety	The manual, individual quick-release feature allows individual cows to be released for special handling and sorting. A fully-suspended splash shield (with no posts in the way of the operator) allows for safe, easy operator access during milking. The splash shield also allows for easier cleaning.
Throughput	The vertical lift exit gate includes cow containment gates and posts that move completely up and out of the way, allowing unobstructed cow exit. Sequence gates lift up and out of the way, providing unrestricted access to possible downed animals — with no delay. The sequence gate is spring loaded to allow for quicker loading, which pulls the gate into the load position after cow exit. This spring is easily serviced by the operator. Telescoping entry gate doesn't open against cow flow, so cows enter the parlor faster.



Optional Medallion™ cabinet keeps operators cleaner, reduces noise and protects parlor systems.

По вопросам продаж и поддержки обращайтесь:

Алматы (7273)495-231
Ангарск (3955)60-70-56
Архангельск (8182)63-90-72
Астрахань (8512)99-46-04
Барнаул (3852)73-04-60
Белгород (4722)40-23-64
Благовещенск (4162)22-76-07
Брянск (4832)59-03-52
Владивосток (423)249-28-31
Владикавказ (8672)28-90-48
Владимир (4922)49-43-18
Волгоград (844)278-03-48
Вологда (8172)26-41-59
Воронеж (473)204-51-73
Екатеринбург (343)384-55-89
Иваново (4932)77-34-06
Ижевск (3412)26-03-58
Иркутск (395)279-98-46
Казань (843)206-01-48

Калининград (4012)72-03-81
Калуга (4842)92-23-67
Кемерово (3842)65-04-62
Киров (8332)68-02-04
Коломна (4966)23-41-49
Кострома (4942)77-07-48
Краснодар (861)203-40-90
Красноярск (391)204-63-61
Курган (3522)50-90-47
Курск (4712)77-13-04
Липецк (4742)52-20-81
Магнитогорск (3519)55-03-13
Москва (495)268-04-70
Мурманск (8152)59-64-93
Набережные Челны (8552)20-53-41
Нижний Новгород (831)429-08-12
Новокузнецк (3843)20-46-81
Новосибирск (383)227-86-73
Ноябрьск (3496)41-32-12

Омск (3812)21-46-40
Орел (4862)44-53-42
Оренбург (3532)37-68-04
Пенза (8412)22-31-16
Пермь (342)205-81-47
Петрозаводск (8142)55-98-37
Псков (8112)59-10-37
Ростов-на-Дону (863)308-18-15
Рязань (4912)46-61-64
Самара (846)206-03-16
Санкт-Петербург (812)309-46-40
Саранск (8342)22-96-24
Саратов (845)249-38-78
Севастополь (8692)22-31-93
Симферополь (3652)67-13-56
Смоленск (4812)29-41-54
Сочи (862)225-72-31
Ставрополь (8652)20-65-13
Сургут (3462)77-98-35

Сыктывкар (8212)25-95-17
Тамбов (4752)50-40-97
Тверь (4822)63-31-35
Тольятти (8482)63-91-07
Томск (3822)98-41-53
Тула (4872)33-79-87
Тюмень (3452)66-21-18
Улан-Удэ (3012)59-97-51
Ульяновск (8422)24-23-59
Уфа (347)229-48-12
Хабаровск (4212)92-98-04
Чебоксары (8352)28-53-07
Челябинск (351)202-03-61
Череповец (8202)49-02-64
Чита (3022)38-34-83
Якутск (4112)23-90-97
Ярославль (4852)69-52-93

Россия +7(495)268-04-70

Казахстан +7(7172)727-132

Киргизия +996(312)96-26-47

<https://gea.nt-rt.ru/> || gsg@nt-rt.ru